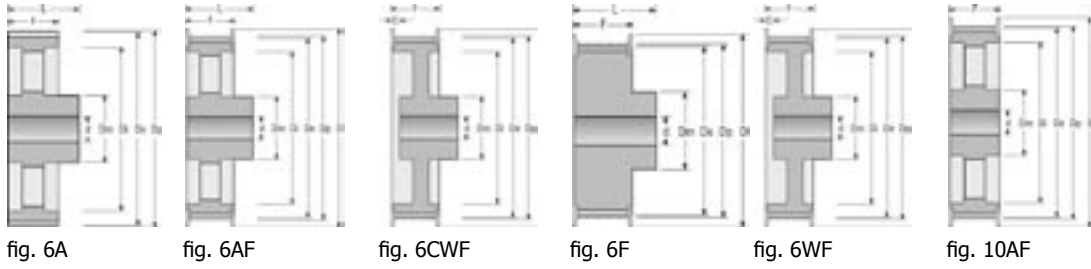

fig. 6F

Teeth	Belt	Mat.	Fig.	Dp	De	Df	Dm	Di	F	L	d	Max	Weight
10	50	ST	6F	30.32	29.59	36	22	19	26	-	6	13	0.11
	75	ST	6F	30.32	29.59	36	22	25	32	-	6	13	0.15
	100	ST	6F	30.32	29.59	36	22	31	38	-	6	13	0.18
12	50	ST	6F	36.38	35.62	42	28	19	26	-	6	17	0.19
	75	ST	6F	36.38	35.62	42	28	25	32	-	8	17	0.23
	100	ST	6F	36.38	35.62	42	28	31	38	-	8	17	0.29
13	50	ST	6F	39.41	38.65	44	30	19	26	-	6	19	0.21
	75	ST	6F	39.41	38.65	44	30	25	32	-	8	19	0.26
	100	ST	6F	39.41	38.65	44	30	31	38	-	8	19	0.30
14	50	ST	6F	42.45	41.68	48	33	19	26	-	8	20	0.25
	75	ST	6F	42.45	41.68	48	33	25	32	-	8	20	0.32
	100	ST	6F	42.45	41.68	48	33	31	38	-	8	20	0.38
15	50	ST	6F	45.48	44.72	51	36	19	26	-	8	23	0.30
	75	ST	6F	45.48	44.72	51	36	25	32	-	8	23	0.35
	100	ST	6F	45.48	44.72	51	36	31	38	-	8	23	0.40
16	50	ST	6F	48.51	47.75	54	38	19	26	-	8	23	0.33
	75	ST	6F	48.51	47.75	54	38	25	32	-	8	23	0.42
	100	ST	6F	48.51	47.75	54	38	31	38	-	8	23	0.51
17	50	ST	6F	51.54	50.78	57	40	19	26	-	10	24	0.36
	75	ST	6F	51.54	50.78	57	40	25	32	-	10	24	0.45
	100	ST	6F	51.54	50.78	57	40	31	38	-	10	24	0.54
18	50	ST	6F	54.57	53.81	60	40	19	26	-	10	24	0.41
	75	ST	6F	54.57	53.81	60	40	25	32	-	10	24	0.51
	100	ST	6F	54.57	53.81	60	40	31	38	-	10	24	0.62
19	50	ST	6F	57.61	56.84	60	40	19	26	-	10	24	0.45
	75	ST	6F	57.61	56.84	60	40	25	32	-	10	24	0.57
	100	ST	6F	57.61	56.84	60	40	31	38	-	10	24	0.69
20	50	ST	6F	60.64	59.88	66	46	19	26	-	10	28	0.50
	75	ST	6F	60.64	59.88	66	46	25	32	-	10	28	0.63
	100	ST	6F	60.64	59.88	66	46	31	38	-	10	28	0.76
21	50	ST	6F	63.67	62.91	71	46	19	26	-	10	28	0.55
	75	ST	6F	63.67	62.91	71	46	25	32	-	10	28	0.70
	100	ST	6F	63.67	62.91	71	46	31	38	-	10	28	0.82
22	50	ST	6F	66.70	65.94	75	50	19	26	-	10	30	0.62
	75	ST	6F	66.70	65.94	75	50	25	32	-	10	30	0.75
	100	ST	6F	66.70	65.94	75	50	31	38	-	10	30	0.92
24	50	ST	6F	72.77	72.00	79	50	19	26	-	12	30	0.68
	75	ST	6F	72.77	72.00	79	50	25	32	-	12	30	0.85
	100	ST	6F	72.77	72.00	79	50	31	38	-	12	30	1.10
26	50	ST	6F	78.83	78.07	87	50	19	26	-	12	30	0.82
	75	ST	6F	78.83	78.07	87	50	25	32	-	12	30	1.00
	100	ST	6F	78.83	78.07	87	50	31	38	-	12	30	1.30
28	50	ST	6F	84.89	84.13	91	50	19	26	-	12	30	0.92
	75	ST	6F	84.89	84.13	91	50	25	32	-	12	30	1.20
	100	ST	6F	84.89	84.13	91	50	31	38	-	12	30	1.40
30	50	ST	6F	90.96	90.20	97	50	19	26	-	12	30	1.10
	75	ST	6F	90.96	90.20	97	50	25	32	-	12	30	1.40
	100	ST	6F	90.96	90.20	97	50	31	38	-	12	30	1.70
32	50	ST	6F	97.02	96.26	103	50	19	26	-	12	30	1.20
	75	ST	6F	97.02	96.26	103	50	25	32	-	12	30	1.50
	100	ST	6F	97.02	96.26	103	50	31	38	-	12	30	1.80
36	50	GG	6WF	109.15	108.39	115	50	19	26	-	12	30	1.00
	75	GG	6WF	109.15	108.39	115	55	25	32	-	12	32	1.30
	100	GG	6CWF	109.15	108.39	115	55	32	32	6	12	32	1.50



Teeth	Belt	Mat.	Fig.	Dp	De	Df	Dm	Di	F	L	d	Max	Weight
40	50	GG	6WF	121.28	120.51	127	50	19	26	-	12	30	1.10
	75	GG	6WF	121.28	120.51	127	60	25	32	-	12	35	1.60
	100	GG	6CWF	121.28	120.51	127	60	32	32	6	12	35	1.80
44	50	GG	6AF	133.40	132.64	140	50	19	26	-	12	30	1.20
	75	GG	6AF	133.40	132.64	140	60	25	32	-	12	35	1.70
	100	GG	10AF	133.40	132.64	140	60	32	-	-	12	35	1.90
48	50	GG	6AF	145.53	144.77	152	50	19	26	-	12	30	1.30
	75	GG	6AF	145.53	144.77	152	60	25	32	-	12	35	1.90
	100	GG	10AF	145.53	144.77	152	60	32	-	-	12	35	2.10
60	50	GG	6A	181.91	181.15	-	50	19	28	-	15	30	1.30
	75	GG	6A	181.91	181.15	-	60	26	35	-	15	35	1.80
	100	GG	6A	181.91	181.15	-	60	32	35	-	15	35	2.00
72	50	GG	6A	218.30	217.53	-	50	19	28	-	15	30	1.70
	75	GG	6A	218.30	217.53	-	60	26	35	-	15	35	2.30
	100	GG	6A	218.30	217.53	-	60	32	35	-	15	35	2.50
84	50	GG	6A	254.68	253.92	-	50	19	28	-	15	30	1.90
	75	GG	6A	254.68	253.92	-	60	29	35	-	15	35	2.50
	100	GG	6A	254.68	253.92	-	60	32	35	-	15	35	2.70

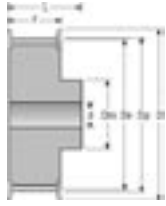

fig. 6F

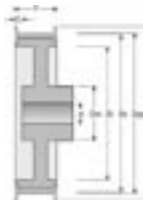

fig. 6CWF

Teeth	Belt	Mat.	Fig.	Dp	De	Df	Dm	F	L	E	d	Max.	Weight
14	75	ST	6F	56.60	55.22	64	40	26.4	40	-	10	24	0.50
	100	ST	6F	56.60	55.22	63	40	31	41	-	10	24	0.65
	150	ST	6F	56.60	55.22	63	40	44	54	-	12	24	0.82
	200	ST	6F	56.60	55.22	63	40	58	68	-	12	24	1.10
16	75	ST	6F	64.68	63.31	70	46	26.4	40	-	10	28	0.60
	100	ST	6F	64.68	63.31	71	46	31	41	-	10	28	0.85
	150	ST	6F	64.68	63.31	71	46	44	54	-	12	28	1.10
	200	ST	6F	64.68	63.31	71	46	58	68	-	15	28	1.40
	300	ST	6F	64.68	63.31	71	46	84	94	-	15	28	2.00
18	75	ST	6F	72.77	71.39	79	54	26.4	40	-	12	32	0.80
	100	ST	6F	72.77	71.39	79	54	31	41	-	12	32	1.10
	150	ST	6F	72.77	71.39	79	54	44	54	-	12	32	1.50
	200	ST	6F	72.77	71.39	79	54	58	68	-	15	32	1.80
	300	ST	6F	72.77	71.39	79	54	84	94	-	15	32	2.60
19	75	ST	6F	76.81	75.44	82.5	58	26.4	40	-	12	34	1.00
	100	ST	6F	76.81	75.44	82	58	31	41	-	12	34	1.20
	150	ST	6F	76.81	75.44	82	58	44	54	-	12	34	1.70
	200	ST	6F	76.81	75.44	82	58	58	68	-	15	34	2.10
	300	ST	6F	76.81	75.44	82	58	84	94	-	15	34	2.90
20	75	ST	6F	80.85	79.48	87	62	26.4	40	-	12	35	1.10
	100	ST	6F	80.85	79.48	87	62	31	41	-	12	35	1.40
	150	ST	6F	80.85	79.48	87	62	44	54	-	12	35	1.80
	200	ST	6F	80.85	79.48	87	62	58	68	-	15	35	2.30
	300	ST	6F	80.85	79.48	87	62	84	94	-	15	35	3.20
21	75	ST	6F	84.89	83.52	91	67	26.4	40	-	12	38	1.20
	100	ST	6F	84.89	83.52	91	67	31	41	-	12	38	1.60
	150	ST	6F	84.89	83.52	91	67	44	54	-	12	38	2.20
	200	ST	6F	84.89	83.52	91	67	58	68	-	15	38	2.60
	300	ST	6F	84.89	83.52	91	67	84	94	-	15	38	3.60
22	75	ST	6F	88.94	87.56	94	70	26.4	40	-	12	41	1.40
	100	ST	6F	88.94	87.56	93	70	31	41	-	12	41	1.70
	150	ST	6F	88.94	87.56	93	70	44	54	-	12	41	2.30
	200	ST	6F	88.94	87.56	93	70	58	68	-	15	41	2.80
	300	ST	6F	88.94	87.56	93	70	84	94	-	15	41	4.00
24	75	ST	6F	97.02	95.65	102	75	26.4	40	-	12	45	1.60
	100	ST	6F	97.02	95.65	103	75	31	41	-	12	45	2.00
	150	ST	6F	97.02	95.65	103	75	44	54	-	12	45	2.60
	200	ST	6F	97.02	95.65	103	75	58	68	-	15	45	3.40
	300	ST	6F	97.02	95.65	103	75	84	94	-	15	45	4.70
26	75	ST	6F	105.11	103.73	112	80	26.4	40	-	15	45	1.80
	100	GG	6CWF	105.11	103.73	111	55	32	32	8	15	32	1.40
	150	GG	6CWF	105.11	103.73	111	55	45	35	18	15	32	1.70
	200	GG	6CWF	105.11	103.73	111	60	58	42	24	15	35	2.30
	300	GG	6CWF	105.11	103.73	111	60	84	57	35	15	35	3.30
28	75	GG	6F	113.19	111.82	120	80	26.4	40	-	15	45	2.00
	100	GG	6CWF	113.19	111.82	119	60	32	32	8	15	35	1.60
	150	GG	6CWF	113.19	111.82	119	60	45	35	18	15	35	1.90
	200	GG	6CWF	113.19	111.82	119	60	58	42	24	15	35	2.50
	300	GG	6CWF	113.19	111.82	119	60	84	57	35	15	35	3.60
30	75	GG	6F	121.28	119.90	128	80	26.4	40	-	15	45	2.10
	100	GG	6CWF	121.28	119.90	127	60	32	32	8	15	35	1.70
	150	GG	6CWF	121.28	119.90	127	60	45	35	18	15	35	2.10
	200	GG	6CWF	121.28	119.90	127	70	58	42	24	15	40	2.90
	300	GG	6CWF	121.28	119.90	127	70	84	57	35	15	40	4.20

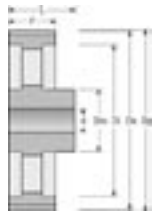

fig. 6A

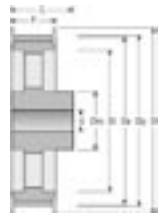

fig. 6AF

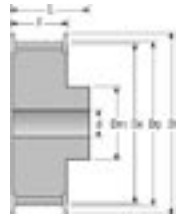

fig. 6F

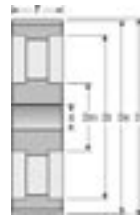

fig. 10A

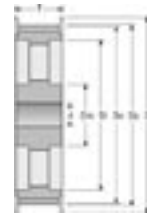

fig. 10AF



fig. 11A

Teeth	Belt	Mat.	Fig.	Dp	De	Df	Dm	F	L	E	d	Max.	Weight
32	75	GG	6F	129.36	127.99	135	70	27	40	15	15	40	2.20
	100	GG	6WF	129.36	127.99	135	70	32	40	-	20	40	2.20
	150	GG	6CWF	129.36	127.99	135	70	45	45	8	20	40	2.60
	200	GG	6CWF	129.36	127.99	135	70	58	47	19	20	40	3.20
	300	GG	6CWF	129.36	127.99	135	70	84	57	35	20	40	4.30
36	75	GG	6F	145.53	144.16	152	80	26.4	40	-	20	45	2.40
	100	GG	6WF	145.53	144.16	152	80	32	40	-	20	45	3.00
	150	GG	6CWF	145.53	144.16	152	80	45	45	8	20	45	3.20
	200	GG	6CWF	145.53	144.16	152	80	58	47	19	20	45	3.80
	300	GG	6CWF	145.53	144.16	152	80	84	57	35	20	45	5.20
40	75	GG	6F	161.70	160.33	168	80	26.4	40	-	20	45	2.80
	100	GG	6AF	161.70	160.33	168	80	32	40	-	20	45	2.80
	150	GG	10AF	161.70	160.33	168	80	45	-	-	20	45	3.80
	200	GG	11AF	161.70	160.33	168	80	58	45	-	20	45	4.10
	300	GG	11AF	161.70	160.33	168	80	84	55	-	20	45	5.60
44	75	GG	6AF	177.87	176.50	184	80	26.4	40	-	20	45	2.70
	100	GG	6AF	177.87	176.50	184	80	32	40	-	20	45	3.10
	150	GG	10AF	177.87	176.50	184	80	45	-	-	20	45	3.70
	200	GG	11AF	177.87	176.50	184	80	58	45	-	20	45	4.40
	300	GG	11AF	177.87	176.50	184	80	84	55	-	20	45	5.90
48	75	GG	6AF	194.04	192.67	200	90	26.4	40	-	20	45	3.00
	100	GG	6AF	194.04	192.67	200	80	32	40	-	20	45	3.30
	150	GG	10AF	194.04	192.67	200	80	45	-	-	20	45	4.00
	200	GG	11AF	194.04	192.67	200	85	58	45	-	20	48	5.10
	300	GG	11AF	194.04	192.67	200	85	84	55	-	20	48	6.60
60	100	GG	6A	242.55	241.18	-	80	34	45	-	20	45	5.50
	150	GG	10A	242.55	241.18	-	85	46	-	-	20	48	5.10
	200	GG	11A	242.55	241.18	-	90	60	50	-	20	50	7.10
	300	GG	11A	242.55	241.18	-	100	86	55	-	20	57	9.90
72	100	GG	6A	291.06	289.69	-	80	34	45	-	20	45	7.10
	150	GG	10A	291.06	289.69	-	85	46	-	-	20	48	7.90
	200	GG	11A	291.06	289.69	-	90	60	50	-	20	50	8.00
	300	GG	11A	291.06	289.69	-	100	86	55	-	20	57	13.00
84	100	GG	6A	339.57	338.20	-	80	34	45	-	20	45	8.20
	150	GG	10A	339.57	338.20	-	85	46	-	-	20	48	8.90
	200	GG	11A	339.57	338.20	-	90	60	50	-	20	50	12.00
	300	GG	11A	339.57	338.20	-	100	86	55	-	20	57	15.10
96	100	GG	6A	388.08	386.71	-	80	34	45	-	20	45	9.90
	150	GG	10A	388.08	386.71	-	85	46	-	-	20	48	10.10
	200	GG	11A	388.08	386.71	-	90	60	50	-	20	50	13.60
	300	GG	11A	388.08	386.71	-	100	86	55	-	20	57	18.20
120	100	GG	6A	485.10	483.73	-	90	34	50	-	20	50	13.10
	150	GG	6A	485.10	483.73	-	95	46	55	-	24	55	17.20
	200	GG	11A	485.10	483.73	-	100	60	-	-	24	57	16.60
	300	GG	11A	485.10	483.73	-	110	86	65	-	24	62	26.00

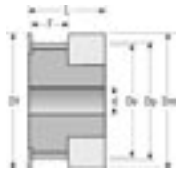

fig. 1F

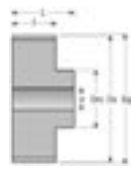

fig. 6

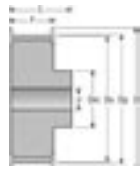

fig. 6F

Teeth	Belt	Mat.	Fig.	Dp	De	Df	Dm	Di	F	L	d	Weight
10	9	AL	1F	9.55	8.79	13.0	13.0	-	10.2	17.5	-	0.004
	15	AL	1F	9.55	8.79	13.0	13.0	-	17.0	26.0	-	0.006
12	9	AL	1F	11.46	10.70	15.0	15.0	-	10.2	17.5	-	0.006
	15	AL	1F	11.46	10.70	15.0	15.0	-	17.0	26.0	-	0.008
14	9	AL	1F	13.37	12.61	16.0	16.0	-	10.2	17.5	-	0.007
	15	AL	1F	13.37	12.61	16.0	16.0	-	17.0	26.0	-	0.010
15	9	AL	1F	14.32	13.56	17.5	17.5	-	10.2	17.5	-	0.008
	15	AL	1F	14.32	13.56	17.5	17.5	-	17.0	26.0	-	0.012
16	9	AL	6F	15.28	14.52	18.0	9.5	-	12.8	20.6	4.0	0.007
	15	AL	6F	15.28	14.52	18.0	9.5	-	19.5	26.0	4.0	0.010
18	9	AL	6F	17.19	16.43	19.5	10.0	-	12.8	20.6	6.0	0.008
	15	AL	6F	17.19	16.43	19.5	10.0	-	19.5	26.0	6.0	0.012
20	9	AL	6F	19.10	18.34	23.0	12.0	-	12.8	20.6	6.0	0.010
	15	AL	6F	19.10	18.34	23.0	12.0	-	19.5	26.0	6.0	0.014
21	9	AL	6F	20.05	19.29	25.0	13.0	-	12.8	20.6	6.0	0.013
	15	AL	6F	20.05	19.29	25.0	13.0	-	19.5	26.0	6.0	0.016
22	9	AL	6F	21.01	20.25	25.0	13.0	-	12.8	20.6	6.0	0.014
	15	AL	6F	21.01	20.25	25.0	13.0	-	19.5	26.0	6.0	0.018
24	9	AL	6F	22.92	22.16	25.0	13.0	-	12.8	20.6	6.0	0.016
	15	AL	6F	22.92	22.16	25.0	13.0	-	19.5	26.0	6.0	0.020
26	9	AL	6F	24.83	24.07	28.0	16.0	-	12.8	20.6	6.0	0.018
	15	AL	6F	24.83	24.07	28.0	16.0	-	19.5	26.0	6.0	0.027
28	9	AL	6F	26.74	25.98	32.0	18.0	-	12.8	20.6	6.0	0.024
	15	AL	6F	26.74	25.98	32.0	18.0	-	19.5	26.0	6.0	0.030
30	9	AL	6F	28.65	27.89	32.0	19.0	-	12.8	20.6	6.0	0.028
	15	AL	6F	28.65	27.89	32.0	19.0	-	19.5	26.0	6.0	0.035
32	9	AL	6F	30.56	29.80	36.0	22.0	-	12.8	20.6	6.0	0.032
	15	AL	6F	30.56	29.80	36.0	22.0	-	19.5	26.0	6.0	0.042
36	9	AL	6F	34.38	33.62	38.0	26.0	-	13.4	22.2	6.0	0.045
	15	AL	6F	34.38	33.62	38.0	26.0	-	20.0	30.0	6.0	0.060
40	9	AL	6F	38.20	37.44	42.0	28.0	-	13.4	22.2	6.0	0.055
	15	AL	6F	38.20	37.44	42.0	28.0	-	20.0	30.0	6.0	0.075
44	9	AL	6F	42.02	41.26	48.0	33.0	-	13.4	22.2	6.0	0.074
	15	AL	6F	42.02	41.26	48.0	33.0	-	20.0	30.0	6.0	0.100
48	9	AL	6	45.84	45.08	-	33.0	-	13.4	22.2	8.0	0.074
	15	AL	6	45.84	45.08	-	33.0	-	20.0	30.0	8.0	0.103
60	9	AL	6	57.30	56.54	-	33.0	-	13.4	22.2	8.0	0.106
	15	AL	6	57.30	56.54	-	33.0	-	20.0	30.0	8.0	0.150
72	9	AL	6	68.75	67.99	-	33.0	-	13.4	22.2	8.0	0.145
	15	AL	6	68.75	67.99	-	33.0	-	20.0	30.0	8.0	0.212

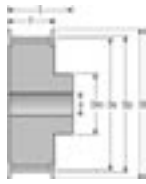

fig. 6F

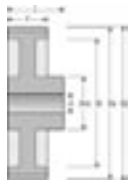

fig. 6W

Teeth	Belt	Mat.	Fig.	Dp	De	Df	Dm	Di	F	L	d	Weight
12	9	ST	6F	19.10	17.96	25.0	13.0	-	14.5	20.0	4.0	0.028
	15	ST	6F	19.10	17.96	25.0	13.0	-	20.5	26.0	4.0	0.034
	25	ST	6F	19.10	17.96	25.0	13.0	-	30.5	36.0	4.0	0.050
14	9	ST	6F	22.28	21.14	25.0	13.0	-	14.5	20.0	6.0	0.034
	15	ST	6F	22.28	21.14	25.0	13.0	-	20.5	26.0	6.0	0.046
	25	ST	6F	22.28	21.14	25.0	13.0	-	30.5	36.0	6.0	0.070
15	9	ST	6F	23.87	22.73	28.0	16.0	-	14.5	20.0	6.0	0.042
	15	ST	6F	23.87	22.73	28.0	16.0	-	20.5	26.0	6.0	0.056
	25	ST	6F	23.87	22.73	28.0	16.0	-	30.5	36.0	6.0	0.080
16	9	ST	6F	25.46	24.32	28.0	16.0	-	14.5	20.0	6.0	0.050
	15	ST	6F	25.46	24.32	28.0	16.0	-	20.5	26.0	6.0	0.064
	25	ST	6F	25.46	24.32	28.0	16.0	-	30.5	36.0	6.0	0.100
18	9	ST	6F	28.65	27.51	32.0	19.0	-	14.5	20.0	6.0	0.070
	15	ST	6F	28.65	27.51	32.0	19.0	-	20.5	26.0	6.0	0.086
	25	ST	6F	28.65	27.51	32.0	19.0	-	30.5	36.0	6.0	0.120
20	9	ST	6F	31.83	30.69	36.0	23.0	-	14.5	22.5	6.0	0.094
	15	ST	6F	31.83	30.69	36.0	23.0	-	20.5	26.0	6.0	0.112
	25	ST	6F	31.83	30.69	36.0	23.0	-	30.5	36.0	6.0	0.160
21	9	ST	6F	33.42	32.28	38.0	24.0	-	14.5	22.5	6.0	0.110
	15	ST	6F	33.42	32.28	38.0	24.0	-	20.5	26.0	6.0	0.130
	25	ST	6F	33.42	32.28	38.0	24.0	-	30.5	38.0	6.0	0.190
22	9	ST	6F	35.01	33.87	38.0	25.5	-	14.5	22.5	6.0	0.118
	15	ST	6F	35.01	33.87	38.0	25.5	-	20.5	26.0	6.0	0.140
	25	ST	6F	35.01	33.87	38.0	25.5	-	30.5	38.0	6.0	0.210
24	9	ST	6F	38.20	37.06	42.0	27.0	-	14.5	22.5	6.0	0.145
	15	ST	6F	38.20	37.06	42.0	27.0	-	20.5	28.0	6.0	0.180
	25	ST	6F	38.20	37.06	42.0	27.0	-	30.5	38.0	6.0	0.250
26	9	ST	6F	41.38	40.24	44.0	30.0	-	14.5	22.5	6.0	0.170
	15	ST	6F	41.38	40.24	44.0	30.0	-	20.5	28.0	6.0	0.220
	25	ST	6F	41.38	40.24	44.0	30.0	-	30.5	38.0	6.0	0.300
28	9	ST	6F	44.56	43.42	48.0	30.5	-	14.5	22.5	6.0	0.200
	15	ST	6F	44.56	43.42	48.0	30.5	-	20.5	28.0	6.0	0.250
	25	ST	6F	44.56	43.42	48.0	30.5	-	30.5	38.0	6.0	0.350
30	9	ST	6F	47.75	46.60	51.0	35.0	-	14.5	22.5	6.0	0.236
	15	ST	6F	47.75	46.60	51.0	35.0	-	20.5	28.0	6.0	0.300
	25	ST	6F	47.75	46.60	51.0	35.0	-	30.5	38.0	6.0	0.420
32	9	ST	6F	50.93	49.79	54.0	38.0	-	14.5	22.5	8.0	0.270
	15	ST	6F	50.93	49.79	54.0	38.0	-	20.5	28.0	8.0	0.350
	25	ST	6F	50.93	49.79	54.0	38.0	-	30.5	38.0	8.0	0.480
36	9	ST	6F	57.30	56.16	60.0	38.0	-	14.5	22.5	8.0	0.324
	15	ST	6F	57.30	56.16	60.0	38.0	-	20.5	28.0	8.0	0.520
	25	ST	6F	57.30	56.16	60.0	38.0	-	30.5	38.0	8.0	0.590
40	9	ST	6F	63.66	62.52	71.00	38.0	-	14.5	22.5	8.0	0.400
	15	ST	6F	63.66	62.52	71.00	38.0	-	20.5	28.0	8.0	0.426
	25	ST	6F	63.66	62.52	71.00	38.0	-	30.5	38.0	8.0	0.740
44	9	AL	6W	70.03	68.89	-	38.0	-	14.5	25.5	8.0	0.170
	15	AL	6W	70.03	68.89	-	38.0	-	20.5	30.0	8.0	0.225
	25	AL	6W	70.03	68.89	-	38.0	-	30.5	40.0	8.0	0.320
48	9	AL	6W	76.39	75.25	-	45.0	-	14.5	25.5	8.0	0.182
	15	AL	6W	76.39	75.25	-	38.0	-	20.5	30.0	8.0	0.187
	25	AL	6W	76.39	75.25	-	38.0	-	30.5	40.0	8.0	0.275
60	9	AL	6W	95.49	94.35	-	45.0	-	14.5	25.5	8.0	0.230
	15	AL	6W	95.49	94.35	-	50.0	-	20.5	30.0	8.0	0.305
	25	AL	6W	95.49	94.35	-	50.0	-	30.5	40.0	8.0	0.435
72	9	AL	6W	114.59	113.45	-	45.0	-	14.5	25.5	8.0	0.270
	15	AL	6W	114.59	113.45	-	50.0	-	20.5	30.0	8.0	0.375
	25	AL	6W	114.59	113.45	-	50.0	-	30.5	40.0	8.0	0.525

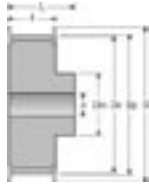

fig. 6F

Teeth	Belt	Mat.	Fig.	Dp	De	Df	Dm	Di	F	L	d	Weight
22	20	ST	6F	56.02	54.65	60.0	43	-	28	38	12	0.54
	30	ST	6F	56.02	54.65	60.0	43	-	38	48	12	0.69
	50	ST	6F	56.02	54.65	60.0	43	-	60	70	12	1.00
	85	ST	6F	56.02	54.65	60.0	43	-	95	105	12	1.55
24	20	ST	6F	61.12	59.75	66.0	45	-	28	38	12	0.65
	30	ST	6F	61.12	59.75	66.0	45	-	38	48	12	0.84
	50	ST	6F	61.12	59.75	66.0	45	-	60	70	12	1.23
	85	ST	6F	61.12	59.75	66.0	45	-	95	105	12	1.90
26	20	ST	6F	66.21	64.84	71.0	50	-	28	38	12	0.80
	30	ST	6F	66.21	64.84	71.0	50	-	38	48	12	1.00
	50	ST	6F	66.21	64.84	71.0	50	-	60	70	12	1.50
	85	ST	6F	66.21	64.84	71.0	50	-	95	105	12	2.25
28	20	ST	6F	71.30	70.08	75.0	50	-	28	38	15	0.87
	30	ST	6F	71.30	70.08	75.0	50	-	38	48	15	1.12
	50	ST	6F	71.30	70.08	75.0	50	-	60	70	15	1.67
	85	ST	6F	71.30	70.08	75.0	50	-	95	105	15	2.55
30	20	ST	6F	76.39	75.13	83.0	55	-	28	38	15	1.02
	30	ST	6F	76.39	75.13	83.0	55	-	38	48	15	1.32
	50	ST	6F	76.39	75.13	83.0	55	-	60	70	15	1.97
	85	ST	6F	76.39	75.13	83.0	55	-	95	105	15	3.00
32	20	ST	6F	81.49	80.16	87.0	60	-	28	38	15	1.20
	30	ST	6F	81.49	80.16	87.0	60	-	38	48	15	1.53
	50	ST	6F	81.49	80.16	87.0	60	-	60	70	15	2.27
	85	ST	6F	81.49	80.16	87.0	60	-	95	105	15	3.57
34	20	ST	6F	86.58	85.22	91.0	70	-	28	38	15	1.40
	30	ST	6F	86.58	85.22	91.0	70	-	38	48	15	1.80
	50	ST	6F	86.58	85.22	91.0	70	-	60	70	15	2.69
	85	ST	6F	86.58	85.22	91.0	70	-	95	105	15	4.00
36	20	ST	6F	91.67	90.30	98.5	70	-	28	38	15	1.55
	30	ST	6F	91.67	90.30	98.5	70	-	38	48	15	1.99
	50	ST	6F	91.67	90.30	98.5	70	-	60	70	15	2.97
	85	ST	6F	91.67	90.30	98.5	70	-	95	105	15	4.50
38	20	ST	6F	96.77	95.39	103.0	75	-	28	38	15	1.65
	30	ST	6F	96.77	95.39	103.0	75	-	38	48	15	2.27
	50	ST	6F	96.77	95.39	103.0	75	-	60	70	15	3.23
	85	ST	6F	96.77	95.39	103.0	75	-	95	105	15	4.90
40	20	GG	6F	101.86	100.49	106.0	75	-	28	38	15	1.74
	30	GG	6F	101.86	100.49	106.0	75	-	38	48	15	2.40
	50	GG	6F	101.86	100.49	106.0	75	-	60	70	18	3.50
	85	GG	6F	101.86	100.49	106.0	75	-	95	105	18	5.20
44	20	GG	6F	112.05	110.67	119.0	75	-	28	38	15	2.10
	30	GG	6F	112.05	110.67	119.0	75	-	38	48	15	2.80
	50	GG	6F	112.05	110.67	119.0	75	-	60	70	18	3.90
	85	GG	6F	112.05	110.67	119.0	75	-	95	105	18	6.60
48	20	GG	6F	122.23	120.86	127.0	75	-	28	38	15	2.44
	30	GG	6F	122.23	120.86	127.0	75	-	38	48	15	3.20
	50	GG	6F	122.23	120.86	127.0	80	-	60	70	18	4.30
	85	GG	6F	122.23	120.86	127.0	80	-	95	105	18	7.60
56	20	GG	6WF	142.60	141.23	148.0	80	117	28	38	15	2.60
	30	GG	6WF	142.60	141.23	148.0	90	117	38	48	15	3.60
	50	GG	10WF	142.60	141.23	148.0	90	117	60	60	18	5.00
	85	GG	6F	142.60	141.23	148.0	80	-	95	105	20	9.80

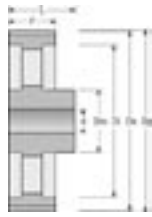

fig. 6A

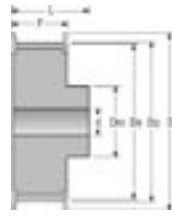

fig. 6F

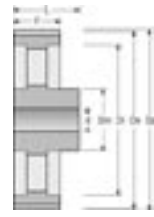

fig. 6WF

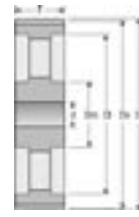

fig. 10A

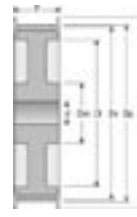

fig. 10WF

Teeth	Belt	Mat.	Fig.	Dp	De	Df	Dm	Di	F	L	d	Weight
64	20	GG	6WF	162.97	161.60	168.0	80	137	28	38	15	2.90
	30	GG	6WF	162.97	161.60	168.0	90	137	38	48	15	4.30
	50	GG	10WF	162.97	161.60	168.0	100	137	60	60	18	5.60
72	85	GG	10WF	162.97	161.60	168.0	100	137	95	95	20	10.40
	20	GG	6WF	183.35	181.97	192.0	80	158	28	38	15	3.10
	30	GG	6WF	183.35	181.97	192.0	95	158	38	48	15	4.80
80	50	GG	10WF	183.35	181.97	192.0	100	158	60	60	18	6.80
	85	GG	10WF	183.35	181.97	192.0	110	158	95	95	20	11.40
	20	GG	6A	203.72	202.35	-	90	180	28	38	15	3.80
90	30	GG	6A	203.72	202.35	-	100	180	38	48	15	5.10
	50	GG	10A	203.72	202.35	-	110	180	60	60	18	6.90
	85	GG	10A	203.72	202.35	-	110	180	95	95	20	11.10
112	20	GG	6A	229.18	227.81	-	90	204	28	38	15	4.20
	30	GG	6A	229.18	227.81	-	100	204	38	48	15	5.70
	50	GG	10A	229.18	227.81	-	110	204	60	60	18	8.60
144	85	GG	10A	229.18	227.81	-	110	204	95	95	20	13.20
	20	GG	6A	285.21	283.83	-	90	260	28	38	18	5.20
	30	GG	6A	285.21	283.83	-	100	260	38	48	18	6.80
168	50	GG	10A	285.21	283.83	-	110	260	60	60	18	9.60
	85	GG	10A	285.21	283.83	-	110	260	95	95	24	16.30
	20	GG	6A	366.69	365.32	-	90	341	28	38	20	7.50
192	30	GG	6A	366.69	365.32	-	100	341	38	48	20	9.30
	50	GG	10A	366.69	365.32	-	110	341	60	60	20	13.80
	85	GG	10A	366.69	365.32	-	120	341	95	95	24	21.50
224	20	GG	6A	427.81	426.44	-	100	402	28	38	20	10.00
	30	GG	6A	427.81	426.44	-	100	402	38	48	20	11.40
	50	GG	10A	427.81	426.44	-	120	402	60	60	20	16.00
256	85	GG	10A	427.81	426.44	-	120	402	95	95	24	26.10
	20	GG	6A	488.92	487.55	-	100	463	28	38	20	14.40
	30	GG	6A	488.92	487.55	-	100	463	38	48	20	16.00
288	50	GG	10A	488.92	487.55	-	130	463	60	60	20	22.40
	85	GG	10A	488.92	487.55	-	130	463	95	95	24	30.60

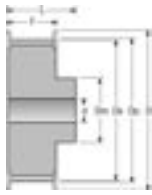

fig. 6F

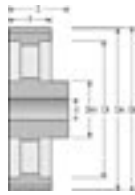

fig. 6WF



fig. 10WF

Teeth	Belt	Mat.	Fig.	Dp	De	Df	Dm	Di	F	L	d	Weight
28	40	GG	6F	124.78	122.12	127	100	-	54	69	24	4.73
	55	GG	6F	124.78	122.12	127	100	-	70	85	24	5.60
	85	GG	6F	124.78	122.12	127	100	-	102	117	24	7.70
	115	GG	6F	124.78	122.12	127	100	-	133	148	32	9.20
	170	GG	6F	124.78	122.12	127	100	-	187	202	32	13.80
29	40	GG	6F	129.23	126.57	138	100	-	54	69	24	5.09
	55	GG	6F	129.23	126.57	138	100	-	70	85	24	6.10
	85	GG	6F	129.23	126.57	138	100	-	102	117	24	8.40
	115	GG	6F	129.23	126.57	138	100	-	133	148	32	10.20
	170	GG	6F	129.23	126.57	138	100	-	187	202	32	14.20
30	40	GG	6F	133.69	130.99	138	100	-	54	69	24	5.45
	55	GG	6F	133.69	130.99	138	100	-	70	85	24	6.60
	85	GG	6F	133.69	130.99	138	100	-	102	117	24	9.10
	115	GG	6F	133.69	130.99	138	100	-	133	148	32	11.20
	170	GG	6F	133.69	130.99	138	100	-	187	202	32	15.60
32	40	GG	6F	142.60	139.88	154	100	-	54	69	24	6.17
	55	GG	6F	142.60	139.88	154	100	-	70	85	24	7.60
	85	GG	6F	142.60	139.88	154	100	-	102	117	24	10.50
	115	GG	6F	142.60	139.88	154	100	-	133	148	32	13.20
	170	GG	6F	142.60	139.88	154	100	-	187	202	32	18.10
34	40	GG	6F	151.52	148.79	160	100	-	54	69	24	6.88
	55	GG	6F	151.52	148.79	160	100	-	70	85	24	8.60
	85	GG	6F	151.52	148.79	160	100	-	102	117	24	11.90
	115	GG	6F	151.52	148.79	160	100	-	133	148	32	14.80
	170	GG	6F	151.52	148.79	160	100	-	187	202	32	20.40
36	40	GG	6F	160.43	157.68	168	100	-	54	69	24	7.60
	55	GG	6F	160.43	157.68	168	100	-	70	85	24	9.60
	85	GG	6F	160.43	157.68	168	100	-	102	117	32	13.20
	115	GG	6F	160.43	157.68	168	120	-	133	148	32	16.60
	170	GG	6F	160.43	157.68	168	120	-	187	202	32	23.50
38	40	GG	6F	169.34	166.60	183	120	-	54	69	24	8.28
	55	GG	6F	169.34	166.60	183	120	-	70	85	24	10.80
	85	GG	6F	169.34	166.60	183	120	-	102	117	32	15.15
	115	GG	6F	169.34	166.60	183	120	-	133	148	32	19.20
	170	GG	6F	169.34	166.60	183	135	-	187	202	32	26.50
40	40	GG	6F	178.25	175.49	188	120	-	54	69	24	9.26
	55	GG	6F	178.25	175.49	188	120	-	70	85	24	11.20
	85	GG	6F	178.25	175.49	188	135	-	102	117	32	17.10
	115	GG	6F	178.25	175.49	188	135	-	133	148	32	20.56
	170	GG	6F	178.25	175.49	188	140	-	187	202	32	30.10
44	40	GG	6F	196.08	193.28	211	120	-	54	69	24	10.32
	55	GG	6F	196.08	193.28	211	120	-	70	85	24	12.50
	85	GG	6F	196.08	193.28	211	135	-	102	117	32	23.30
	115	GG	6F	196.08	193.28	211	140	-	133	148	32	28.00
	170	GG	6F	196.08	193.28	211	160	-	187	202	32	37.80
48	40	GG	6WF	213.90	211.11	226	135	172	54	69	24	11.50
	55	GG	10WF	213.90	211.11	226	135	172	70	70	24	13.70
	85	GG	6F	213.90	211.11	226	150	-	102	117	32	25.00
	115	GG	6F	213.90	211.11	226	150	-	133	148	32	35.00
	170	GG	6F	213.90	211.11	226	160	-	187	202	32	44.50
56	40	GG	6WF	249.55	246.76	256	135	207	54	69	28	13.05
	55	GG	10WF	249.55	246.76	256	135	207	70	70	28	14.50
	85	GG	10WF	249.55	246.76	256	150	207	102	102	32	25.00
	115	GG	6F	249.55	246.76	256	150	-	133	148	32	27.50
	170	GG	6F	249.55	246.76	256	160	-	187	202	32	61.00

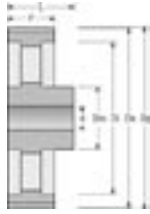

fig. 6A

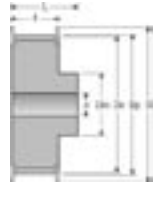

fig. 6F

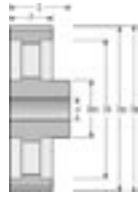

fig. 6WF



fig. 10A

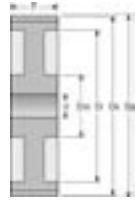

fig. 10W

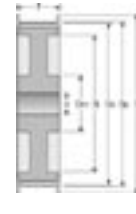

fig. 10WF

Teeth	Belt	Mat.	Fig.	Dp	De	Df	Dm	Di	F	L	d	Weight
64	40	GG	6WF	285.21	282.41	296	135	242	54	69	28	14.40
	55	GG	10WF	285.21	282.41	296	135	242	70	70	28	15.60
	85	GG	10WF	285.21	282.41	296	150	242	102	102	32	28.20
	115	GG	10WF	285.21	282.41	296	150	242	133	133	32	36.80
72	170	GG	6F	285.21	282.41	296	180	-	187	202	32	81.00
	40	GG	6A	320.86	318.06	-	135	278	54	69	28	16.90
	55	GG	10A	320.86	318.06	-	135	278	70	70	28	18.50
	85	GG	10A	320.86	318.06	-	150	278	102	102	32	28.80
80	115	GG	10A	320.86	318.06	-	150	278	133	133	32	32.83
	170	GG	10W	320.86	318.06	-	180	278	187	187	32	61.40
	40	GG	6A	356.51	353.71	-	135	314	54	69	28	18.50
	55	GG	10A	356.51	353.71	-	135	314	70	70	28	20.00
90	85	GG	10A	356.51	353.71	-	150	314	102	102	32	30.10
	115	GG	10A	356.51	353.71	-	150	314	133	133	32	35.55
	170	GG	10W	356.51	353.71	-	180	314	187	187	32	65.00
	40	GG	6A	401.07	398.28	-	135	358	54	69	28	20.00
112	55	GG	10A	401.07	398.28	-	135	358	70	70	28	22.60
	85	GG	10A	401.07	398.28	-	150	358	102	102	32	33.00
	115	GG	10A	401.07	398.28	-	150	358	133	133	32	41.00
	170	GG	10A	401.07	398.28	-	180	358	187	187	38	68.00
144	40	GG	6A	499.11	496.32	-	135	456	54	69	28	26.70
	55	GG	10A	499.11	496.32	-	135	456	70	70	28	29.50
	85	GG	10A	499.11	496.32	-	150	456	102	102	32	41.80
	115	GG	10A	499.11	496.32	-	150	456	133	133	32	54.40
168	170	GG	10A	499.11	496.32	-	200	456	187	187	38	87.50
	40	GG	6A	641.71	638.92	-	135	600	54	69	28	35.00
	55	GG	10A	641.71	638.92	-	135	600	70	70	28	39.00
	85	GG	10A	641.71	638.92	-	150	600	102	102	32	52.40
192	115	GG	10A	641.71	638.92	-	165	600	133	133	32	67.80
	170	GG	10A	641.71	638.92	-	220	600	187	187	38	114.80
	40	GG	6A	748.66	745.87	-	135	706	54	69	28	44.20
	55	GG	10A	748.66	745.87	-	135	706	70	70	28	48.50
216	85	GG	10A	748.66	745.87	-	150	706	102	102	32	60.30
	115	GG	10A	748.66	745.87	-	165	706	133	133	32	75.80
	170	GG	10A	748.66	745.87	-	220	706	187	187	38	125.00
	40	GG	6A	855.62	852.82	-	135	813	54	69	28	52.20
192	55	GG	10A	855.62	852.82	-	135	813	70	70	28	57.80
	85	GG	10A	855.62	852.82	-	165	813	102	102	32	70.20
	115	GG	10A	855.62	852.82	-	165	813	133	133	32	88.30
	170	GG	10A	855.62	852.82	-	220	813	187	187	38	136.40
216	40	GG	6A	962.57	959.76	-	150	920	54	69	28	60.00
	55	GG	10A	962.57	959.76	-	150	920	70	70	28	67.00
	85	GG	10A	962.57	959.76	-	165	920	102	102	32	81.00
	115	GG	10A	962.57	959.76	-	165	920	133	133	32	98.00
170	GG	10A	962.57	959.76	-	220	920	187	187	38	147.00	

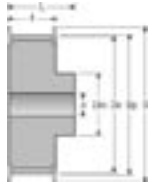

fig. 6F

Teeth	Belt	Mat.	Fig.	De	Df	Dm	F	L	d	Weight
10	10	AL	6F	15.05	19.5	8	15	21	-	0.012
	16	AL	6F	15.05	19.5	8	21	27	-	0.016
	25	AL	6F	15.05	19.5	8	30	36	-	0.023
12	10	AL	6F	18.25	23.0	10	15	21	-	0.016
	16	AL	6F	18.25	23.0	10	21	27	-	0.022
	25	AL	6F	18.25	23.0	10	30	36	-	0.031
14	10	AL	6F	21.45	25.0	13	15	21	-	0.019
	16	AL	6F	21.45	25.0	13	21	27	-	0.026
	25	AL	6F	21.45	25.0	13	30	36	-	0.037
15	10	AL	6F	23.05	28.0	16	15	21	6	0.021
	16	AL	6F	23.05	28.0	16	21	27	6	0.029
	25	AL	6F	23.05	28.0	16	30	36	6	0.041
16	10	AL	6F	24.60	32.0	18	15	21	6	0.025
	16	AL	6F	24.60	32.0	18	21	27	6	0.035
	25	AL	6F	24.60	32.0	18	30	36	6	0.050
18	10	AL	6F	27.80	32.0	19	15	21	6	0.031
	16	AL	6F	27.80	32.0	19	21	27	6	0.043
	25	AL	6F	27.80	32.0	19	30	36	6	0.061
19	10	AL	6F	29.40	36.0	22	15	21	6	0.036
	16	AL	6F	29.40	36.0	22	21	27	6	0.049
	25	AL	6F	29.40	36.0	22	30	36	6	0.070
20	10	AL	6F	31.00	36.0	23	15	21	6	0.038
	16	AL	6F	31.00	36.0	23	21	27	6	0.053
	25	AL	6F	31.00	36.0	23	30	36	6	0.076
22	10	AL	6F	34.25	38.0	24	15	21	6	0.046
	16	AL	6F	34.25	38.0	24	21	27	6	0.054
	25	AL	6F	34.25	38.0	24	30	36	6	0.080
24	10	AL	6F	37.40	42.0	26	15	21	6	0.054
	16	AL	6F	37.40	42.0	26	21	27	6	0.076
	25	AL	6F	37.40	42.0	26	30	36	8	0.109
25	10	AL	6F	39.00	44.0	26	15	21	6	0.058
	16	AL	6F	39.00	44.0	26	21	27	6	0.081
	25	AL	6F	39.00	44.0	26	30	36	8	0.116
26	10	AL	6F	40.60	44.0	26	15	21	6	0.062
	16	AL	6F	40.60	44.0	26	21	27	6	0.085
	25	AL	6F	40.60	44.0	26	30	36	8	0.120
27	10	AL	6F	42.20	48.0	30	15	21	8	0.064
	16	AL	6F	42.20	48.0	30	21	27	8	0.090
	25	AL	6F	42.20	48.0	30	30	36	8	0.128
28	10	AL	6F	43.75	48.0	32	15	21	8	0.071
	16	AL	6F	43.75	48.0	32	21	27	8	0.092
	25	AL	6F	43.75	48.0	32	30	36	8	0.128
30	10	AL	6F	46.95	51.0	34	15	21	8	0.075
	16	AL	6F	46.95	51.0	34	21	27	8	0.105
	25	AL	6F	46.95	51.0	34	30	36	8	0.150
32	10	AL	6F	50.10	54.0	38	15	21	8	0.088
	16	AL	6F	50.10	54.0	38	21	27	8	0.123
	25	AL	6F	50.10	54.0	38	30	36	8	0.176
36	10	AL	6F	56.45	63.0	38	15	21	8	0.114
	16	AL	6F	56.45	63.0	38	21	27	8	0.160
	25	AL	6F	56.45	63.0	38	30	36	8	0.230
40	10	AL	6F	62.85	66.0	40	15	21	8	0.138
	16	AL	6F	62.85	66.0	40	21	27	8	0.193
	25	AL	6F	62.85	66.0	40	30	36	8	0.276

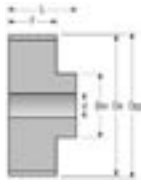

fig. 6

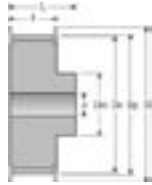

fig. 6F

Teeth	Belt	Mat.	Fig.	De	Df	Dm	F	L	d	Weight
42	10	AL	6F	66.00	71.0	40	15	21	8	0.180
	16	AL	6F	66.00	71.0	40	21	27	8	0.205
	25	AL	6F	66.00	71.0	40	30	36	8	0.284
44	10	AL	6	69.20	-	45	15	21	8	0.185
	16	AL	6	69.20	-	45	21	27	8	0.228
	25	AL	6	69.20	-	45	30	36	8	0.315
48	10	AL	6	75.55	-	50	15	21	8	0.200
	16	AL	6	75.55	-	50	21	27	8	0.280
	25	AL	6	75.55	-	50	30	36	8	0.400
60	10	AL	6	94.65	-	65	15	21	8	0.307
	16	AL	6	94.65	-	65	21	27	8	0.430
	25	AL	6	94.65	-	65	30	36	8	0.614